

iHESS-M series 1P Residential Energy Storage System ALL-IN-ONE



IP65 Rated

Engineered to last with maximum flexibility.
Suitable for outdoor installation



5 Years Warranty

Supplied with a full manufacturers warranty



Simple

All-in-one design
Modular installation
Quick plug connector battery module
removable



Safe

Sleep-class silence
Long battery life

Color

- a
- b
- c
- d

Inverter Module

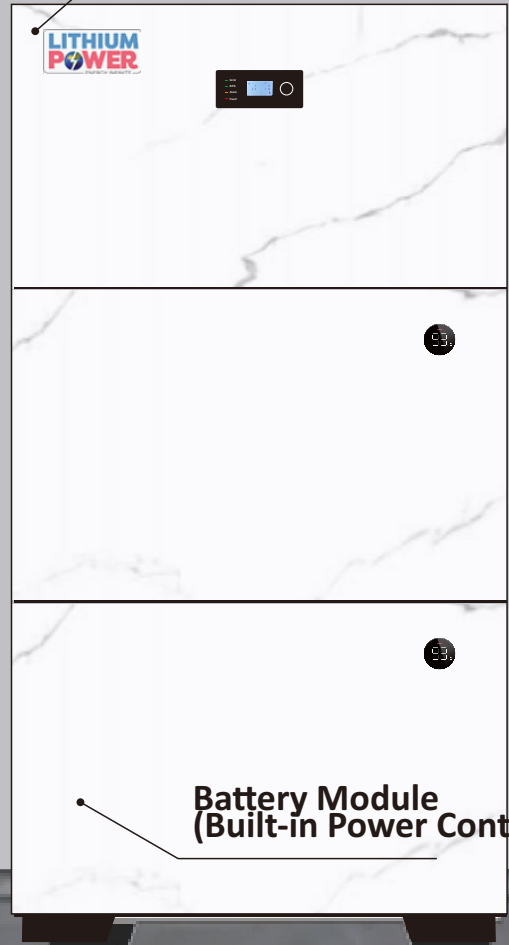

Product application diagram

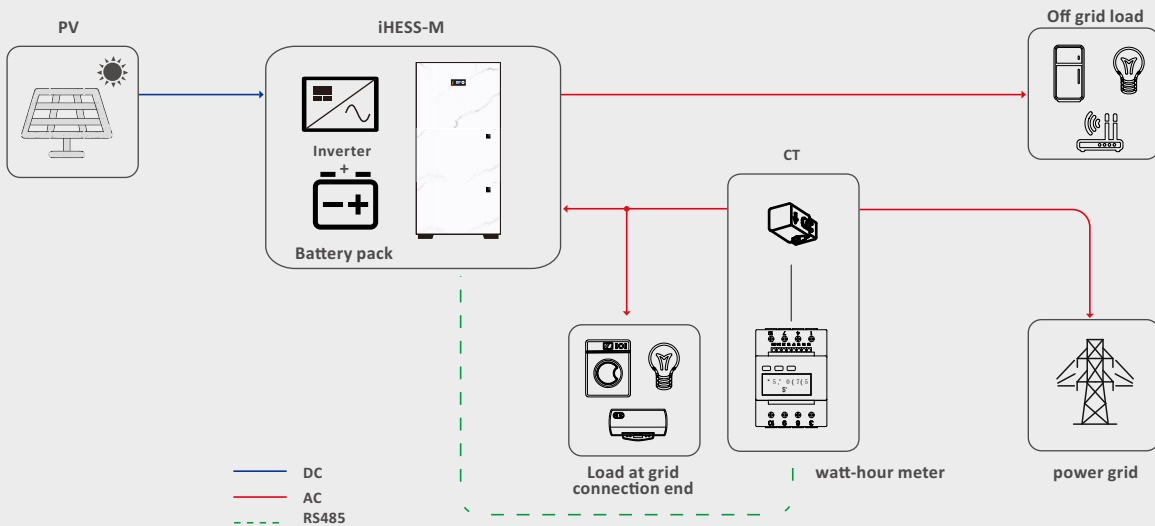

Technical Specification	iHESS-M series
EFFICIENCY	
DC Max. efficiency	97.50%
Europe efficiency	97%
INPUT(PV)	
Max. power(kW)	9.6
Max. DC voltage(V)	550
MPPT voltage range(V)	90~500
Max.input current of single MPPT(A)	16/16
MPPT tracker/strings	2/1
AC OUTPUT	
Rated output power(kW)	6
Max. output current(A)	26
Grid voltage/range(V)	230/176~270
Frequency (Hz)	50 /60
PF	0.8lagging-0.8leading
THDi	<3%
AC output topology	L+N+PE
BATTERY	
Battery voltage range(V)	40~58
Max. charging voltage(V)	58
Max. charge/discharge current(A)	100/110
Battery type	Lithium /Lead-acid
EPS OUTPUT	
Rated power (kW)	6
Rated output voltage(V)	230
Rated output current(A)	26
Rated frequency (Hz)	50/60
Transfer Time(ms)	<10
THDi	<2%
Overload capacity	110%, 30S/120%, 10S/150%, 0.02S
PROTECTION& FEATURE	
Anti-Island protection	Yes
DC overcurrent protection	Yes
Insulation monitoring	Yes
Residual current monitoring	Yes
Arc fault protection	Optional
Battery reverse polarity protection	Yes
Parallel Function	Yes,6 units
Other protection	AC overcurrent, AC overvoltage, Over temperature protection
BATTERY MODULE	
Model	SL-M48100
Battery type	LiFePo4
Battery module energy	5.12KWh
Max charge current&discharge current	100A
Dimensions W x D x H (mm)	640*200*400
Net Weight(KG)	54
GENERAL PARAMETER	
Degree of protection	IP65
Operation temperature	- 25°C~ 60°C
Cooling	Natural
Relative humidity	0 ~95%(non-condensing)
Altitude	(> 2,000m Derating)
Dimensions W * D * H (mm)	480*210*495
Net Weight(KG)	25
Isolation transformer	No
Self-consumption(W)	<5
DISPLAY AND COMMUNICATION	
Display	LCD
Interface	Standard:RS485,CAN,DRM Optional:Wifi ,Bluetooth
Safety standard	CE-EMC/ENIEC 61000-6-3:2021,ENIEC61000-6-1:2019;CEVOC/IEC 62109-1:2010, IEC62109-2:2011, IEC 62477-1: 2022 COC/VDE4105:2018, VDE0124:2020; COC/CE10-21:2022; COC/TORTypeA/B:2022, OVER25:2020; G98:2022, G99:2022